

SIGE Pullout Pantry INSTALLATION INSTRUCTIONS 150-200mm

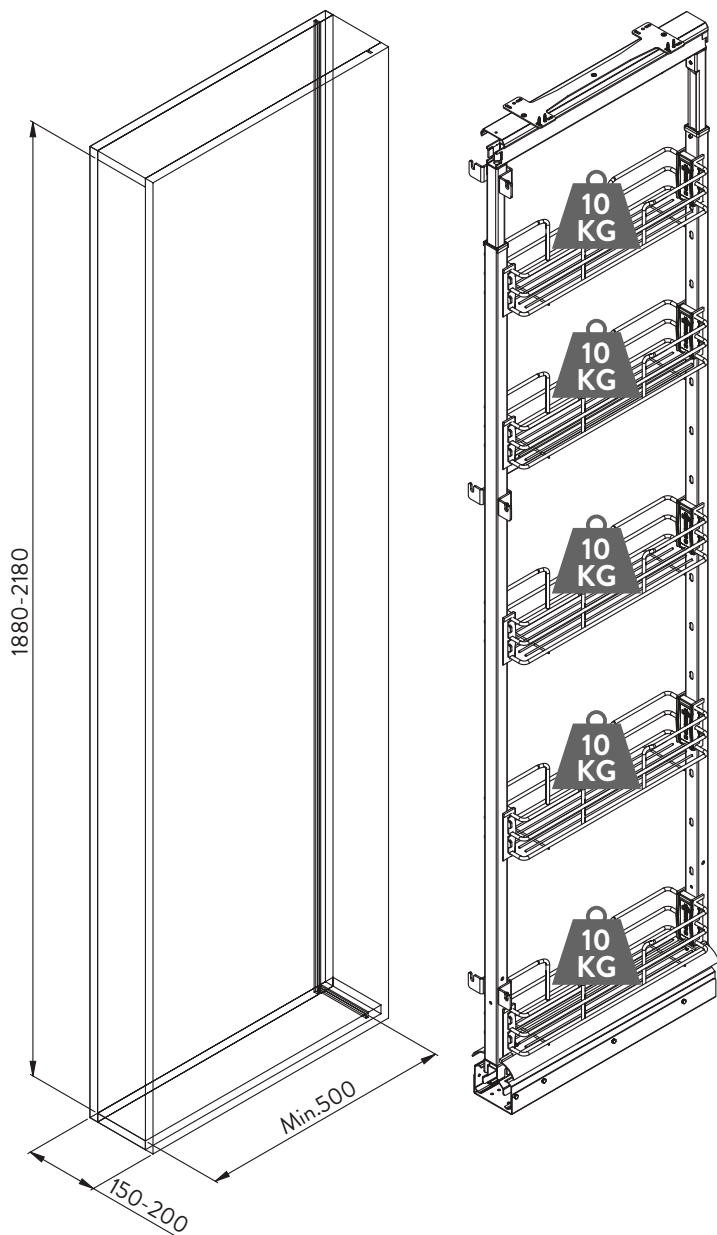

TOOLS



FITTINGS

- 24 x 3.5x18 Self-tapping screws
- 1 x M6x16 Screw
- 1 x M6x25 Screw
- 3 x M5x15 Screw
- 6 x 6.2x13.5 Eurovite Screw
- 1 x Ø3 Key Hexagonal

PARTS

- A. 1 x Bottom Frame
- B. 1 x Top Frame
- C. 1 x Bottom Slide
- D. 1 x Top Slide
- E. 3 x Door bracket
- F. 2 x Fixing Support
- G. 1 x Cover
- H. 1 x Proline Basket & Basket Support Kit

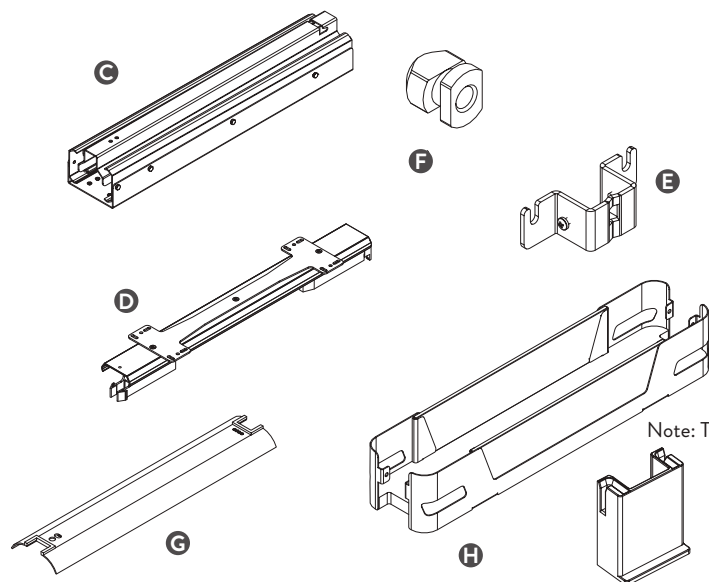

Note: This isnt the Proline Basket

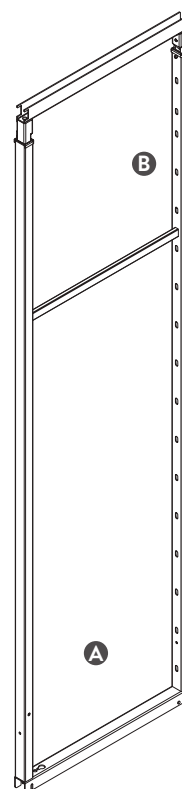

20 x 3.5x18



1

Install the bottom slide C and the top slide D, with the 3.5x18 screws, as shown.

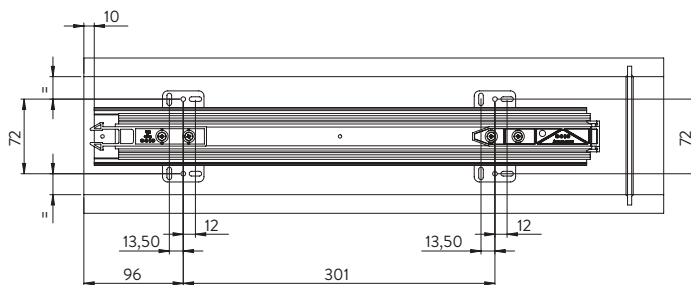
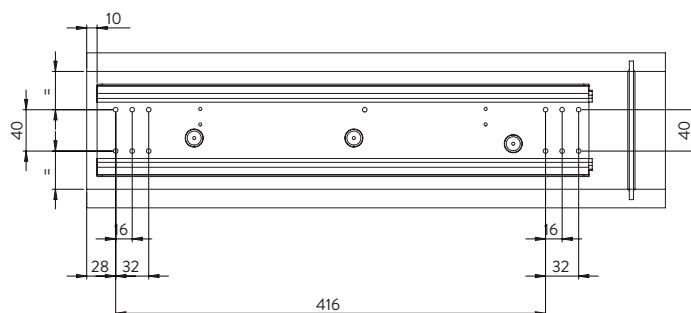
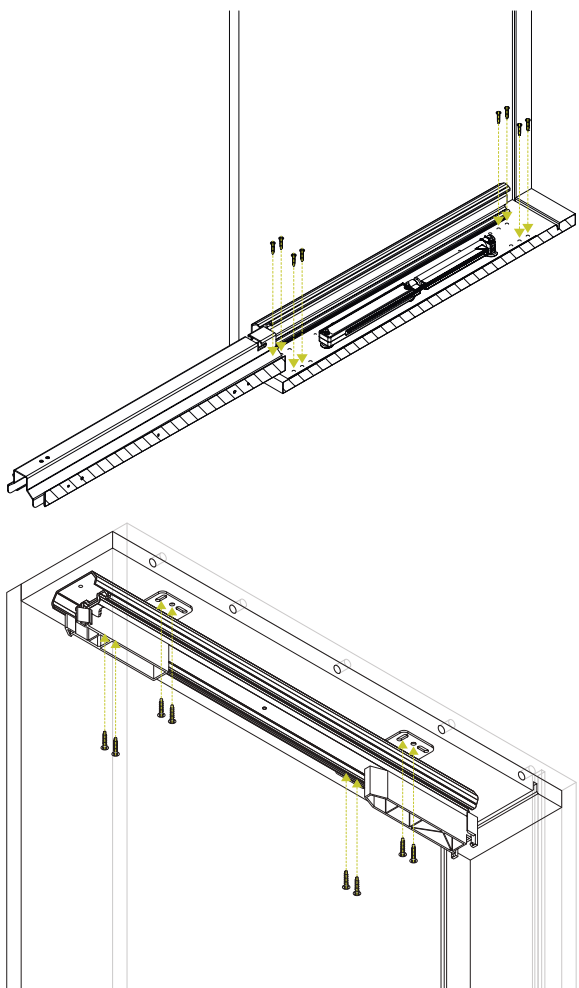

1 x M6x16 & 1 x M6x24



2

Pre-assemble the M6x16 and the M6x24 screws as shown.

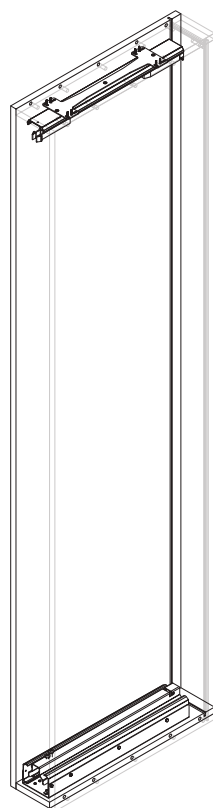
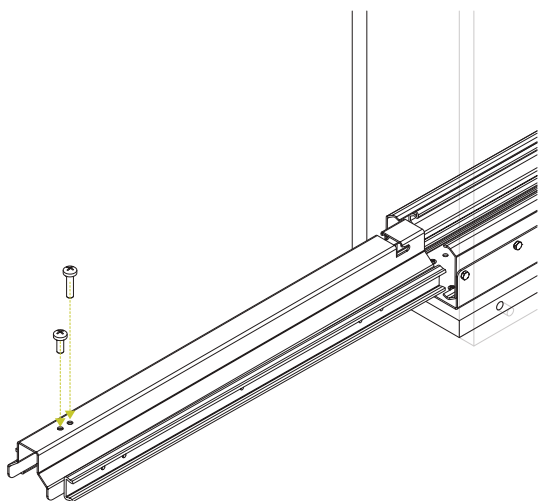

3

Install the A,B frame in to the bottom slide C, fix the A,B frame on the bottom slide C by tightening the M6x24 screw, as shown.

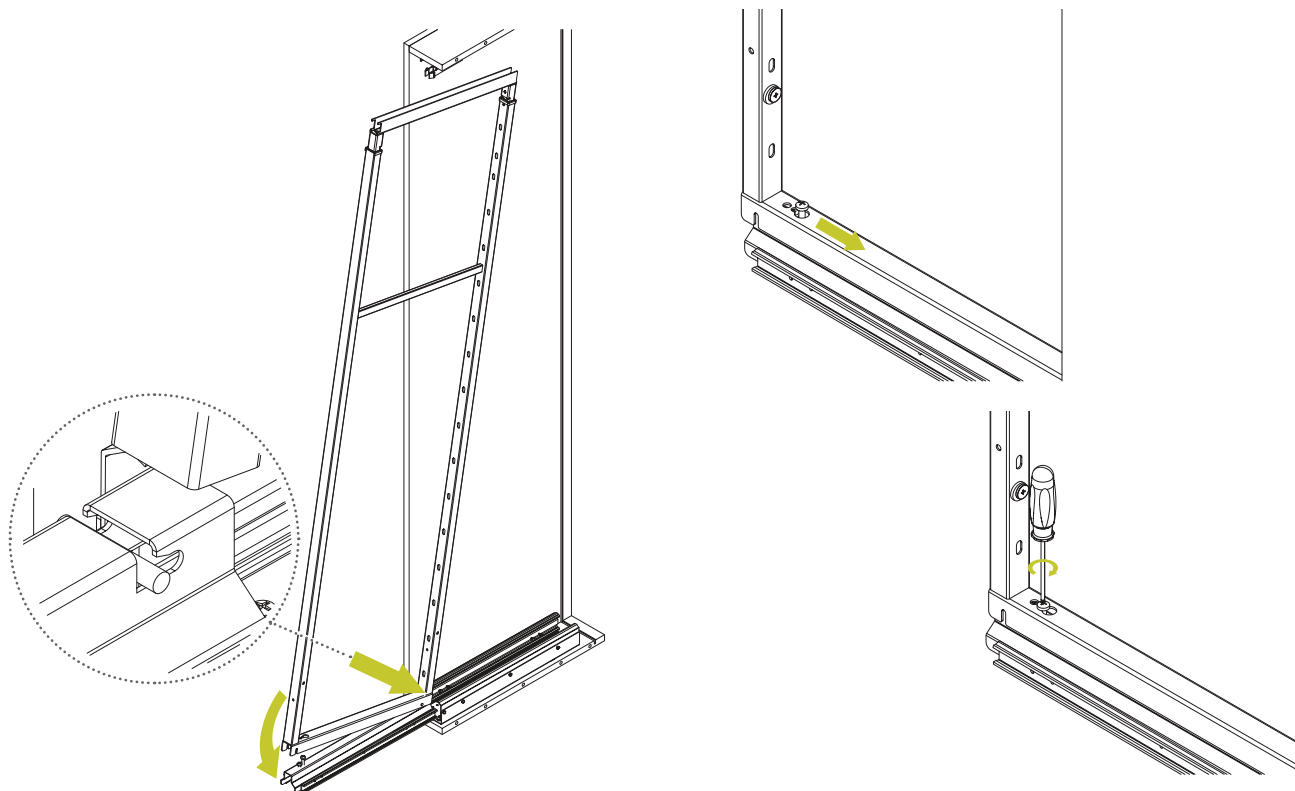

4

Loosen the grains "n" (on the frame A) and slide up the frame B. Block the frame B at the indicated measure by tightening the grains "n". Slide the frame A,B into the top slide D until "click!" to install.

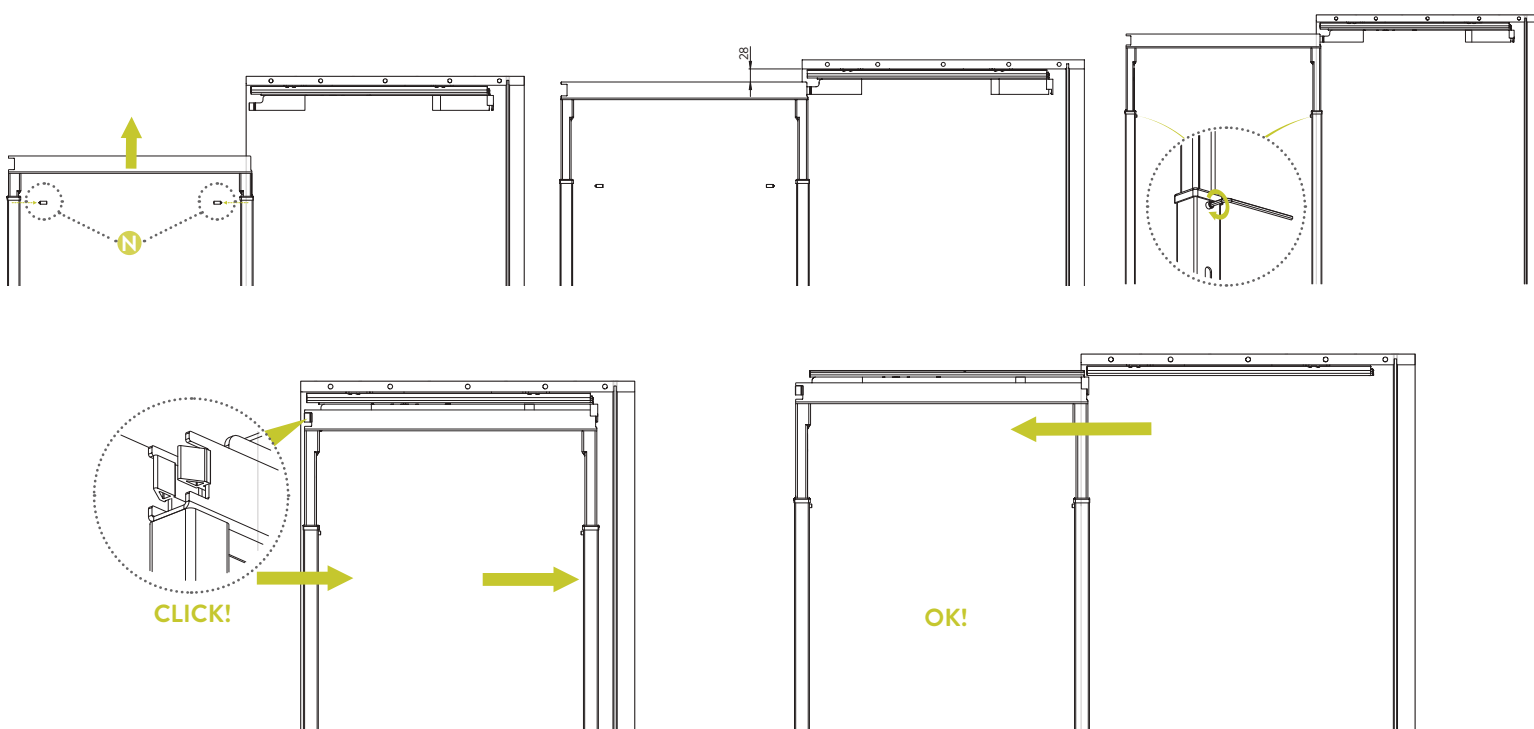

6x 6.2x13.5



5

Choose the position of the middle door bracket E (see measure L), then pre drill, $\varnothing 5 \times 12$ mm, the door according to the measure given.
Pre-assemble the 6.2x13.5 eurovite.

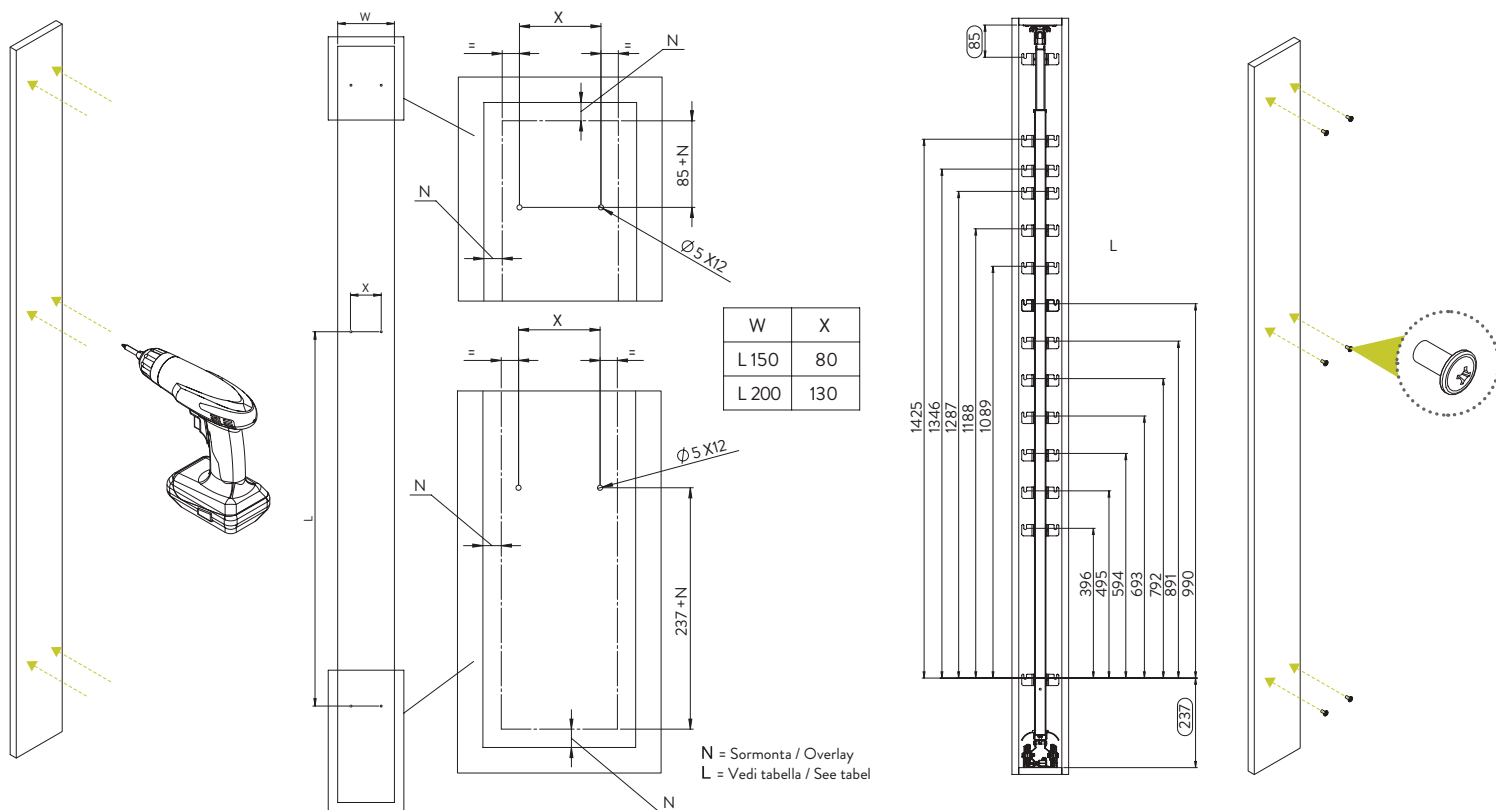

6

Mount the fixing support F, as shown.

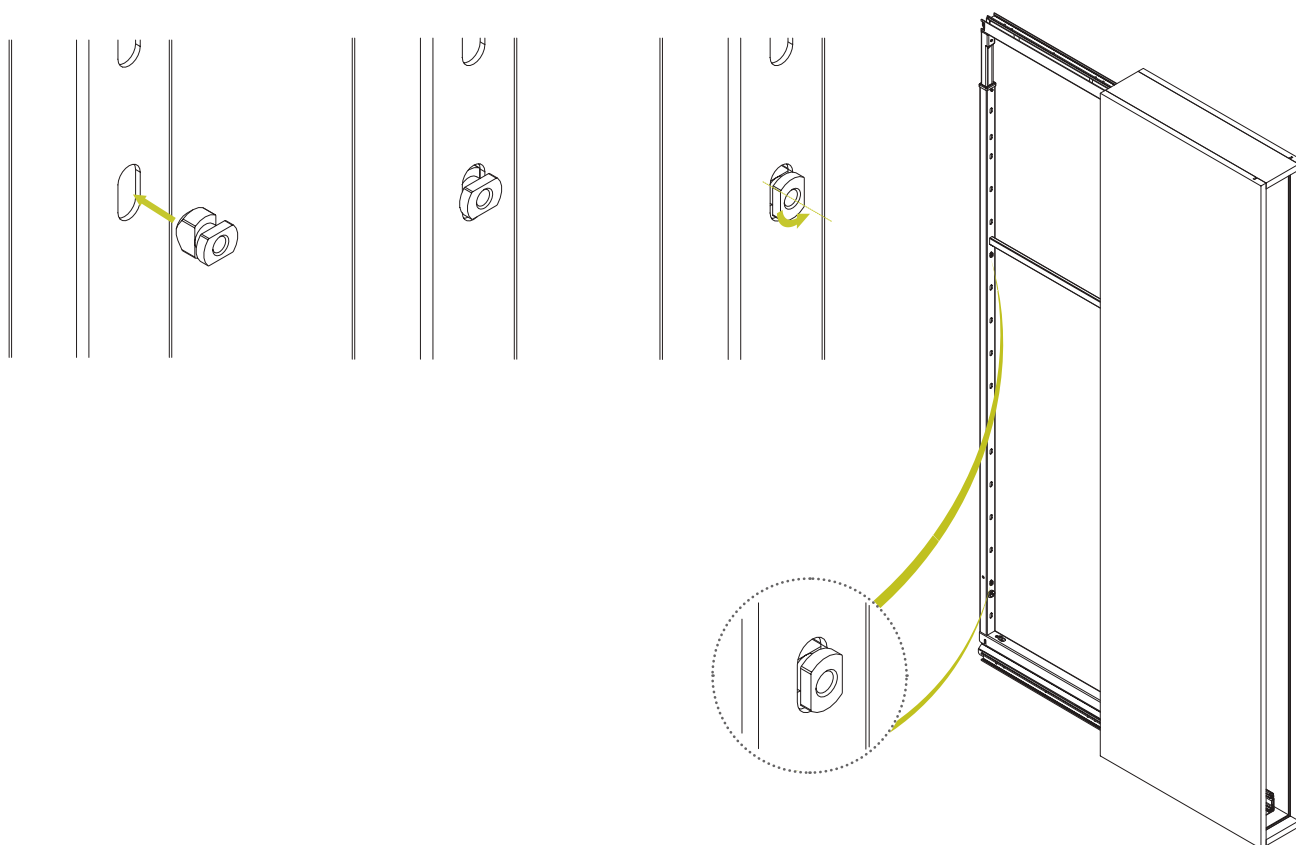

7

3x M5x15



Mount the door bracket E, fix with the M5x15 screws.

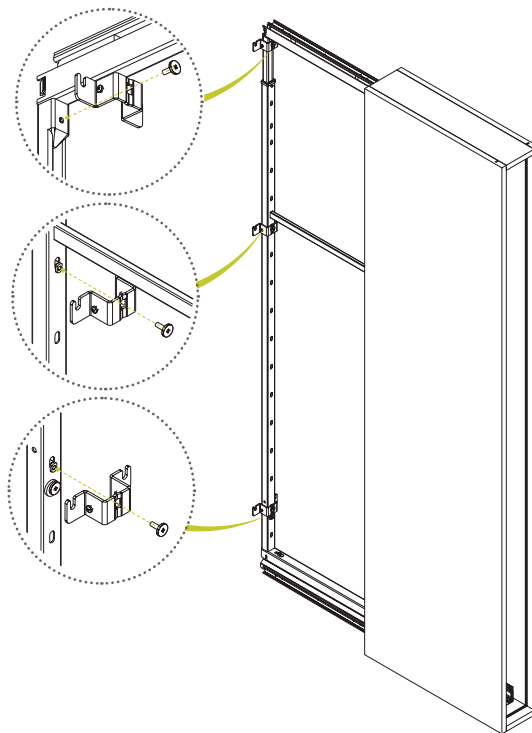

8

Mount the door on the door brackets E, then tighten the six 6.2x3.5 eurovite.

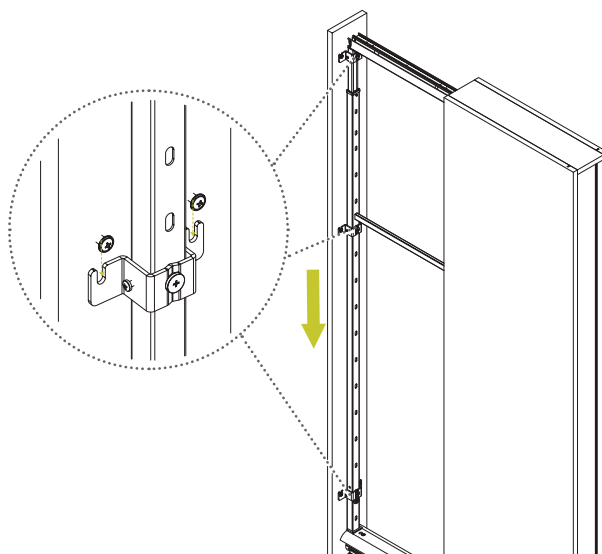
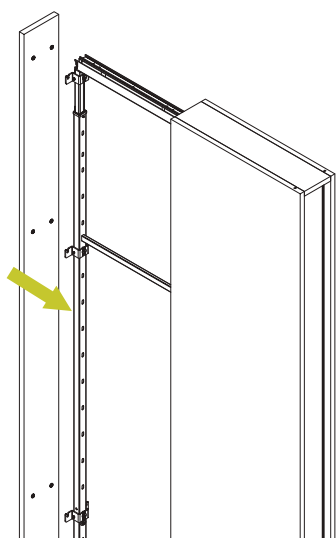

9

Work on the side screws of the door bracket E to adjust the door right and left.

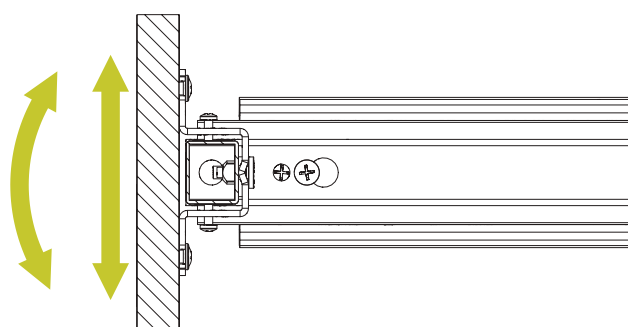
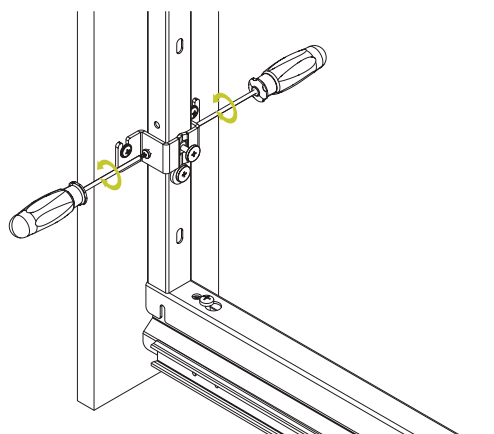



10

Work on the eccentric screw on the bottom frame A to adjust the door up and down.

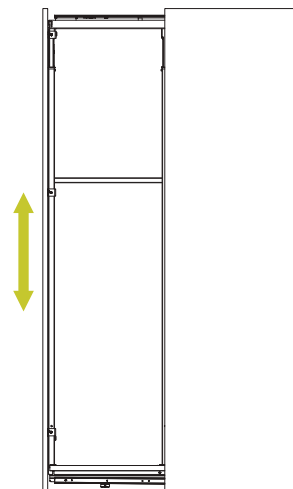
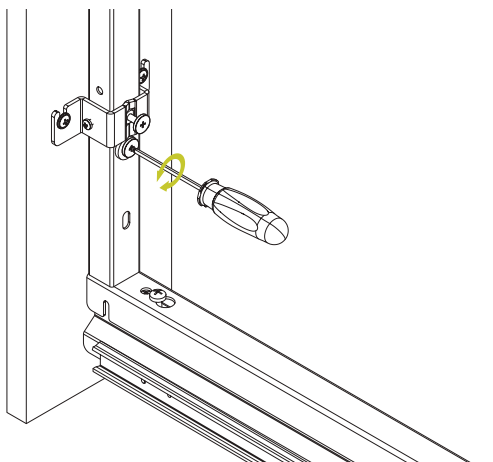

11

Work on the M6x16 e M6x24 screw on the bottom Slide C to adjust the angle of the door.

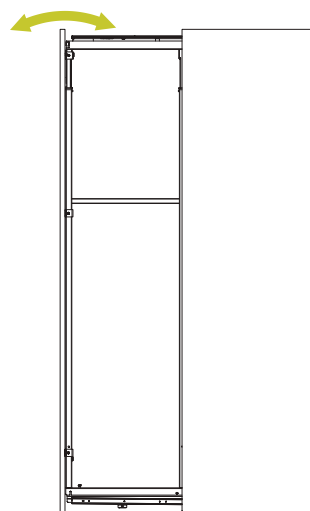
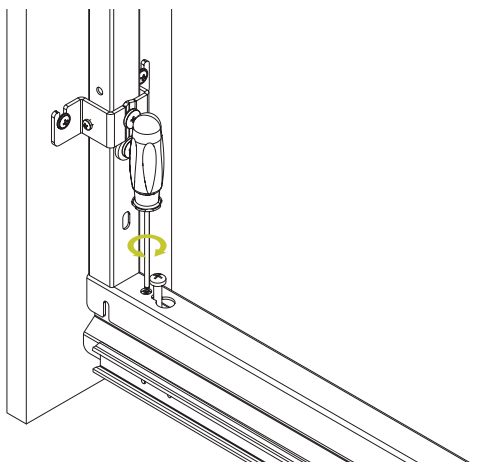

12

Put the cover G as shown.

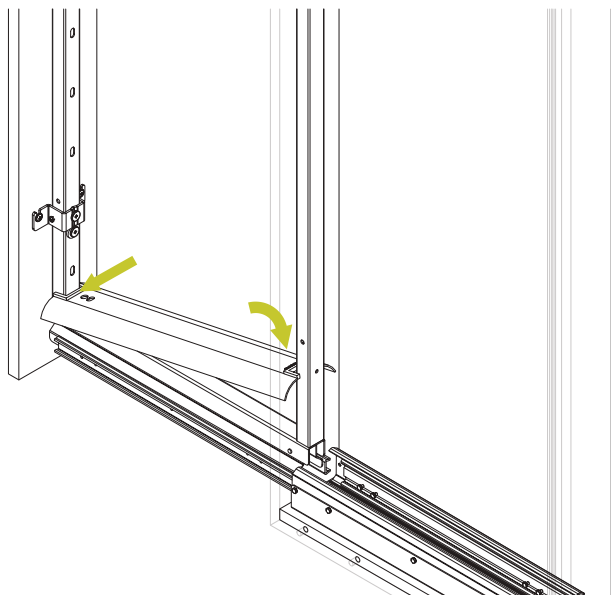

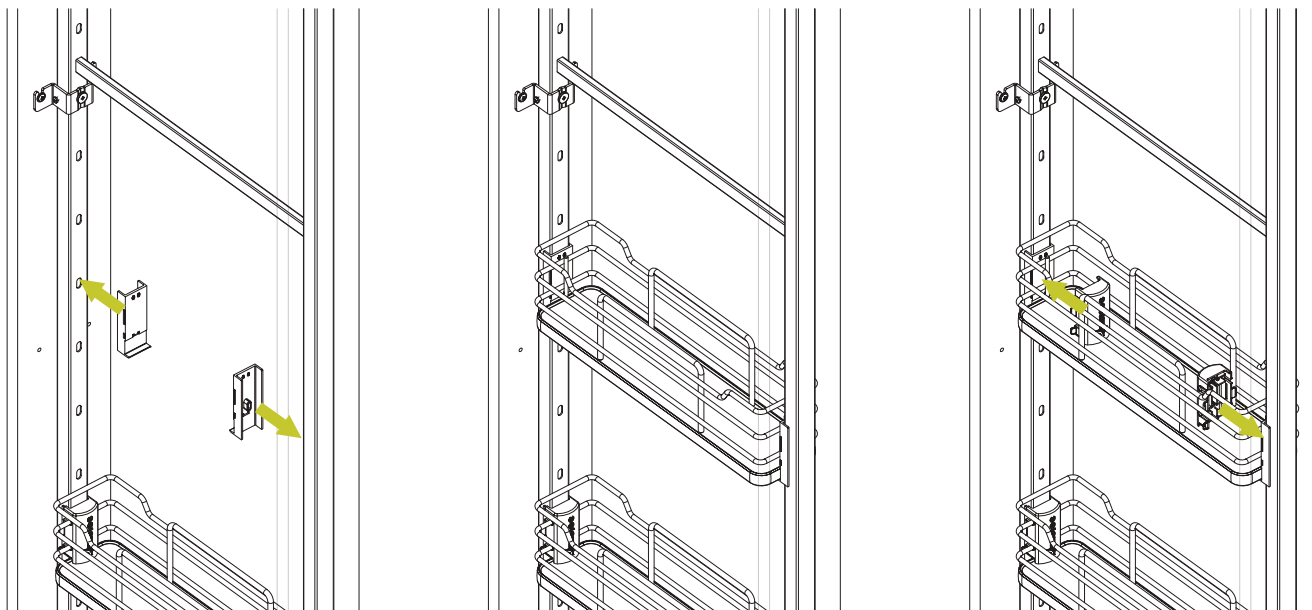

Basket removing.

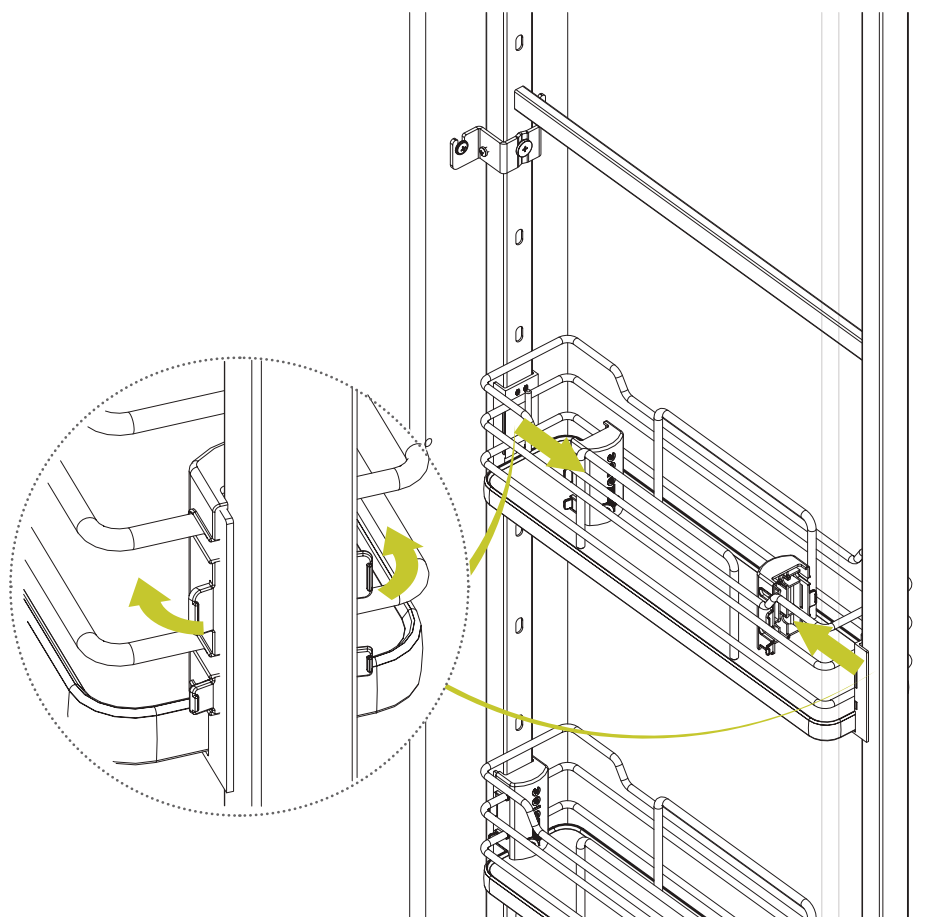



Materia basket mounting.

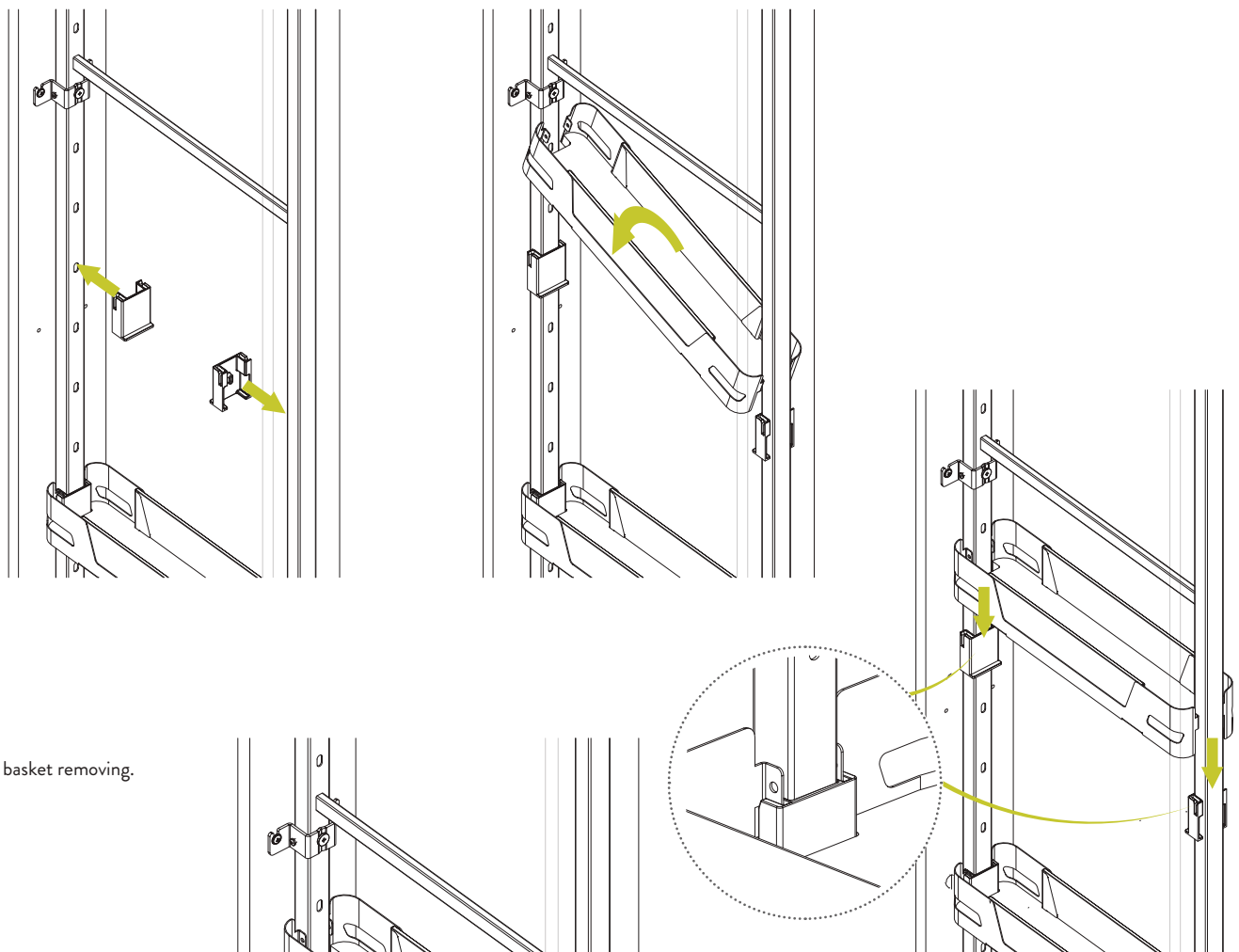

Materia basket removing.

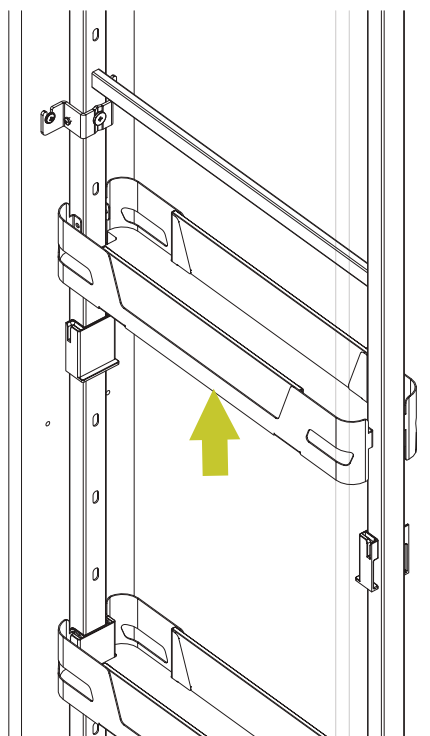

SIGE Pullout Pantry INSTALLATION INSTRUCTIONS 300-600mm

Mechanism for column extractable with kit of full extension slides with soft, capacity 120 kg, complete with brackets for fixing door.

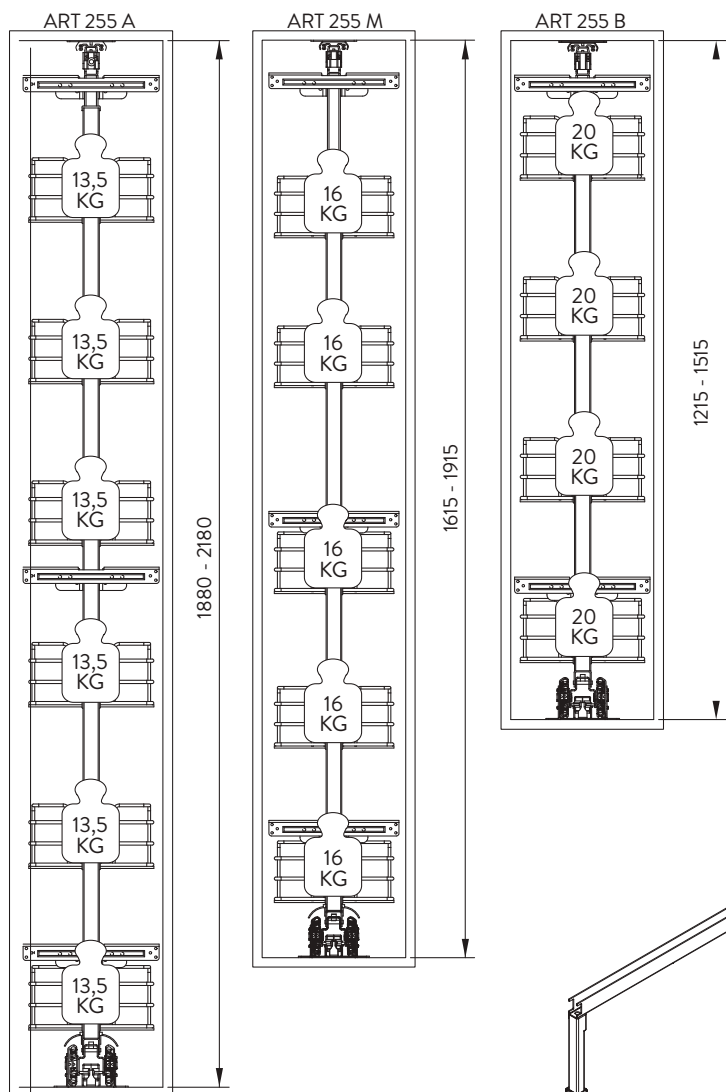

TOOLS



FITTINGS

24 x 3.5x18 Self-tapping screws
1 x M6x16 Screw
1 x M6x25 Screw
3 x M5x15 Screw
1 x Ø3 Key Hexagonal

PARTS

- A. 1 x Lower frame
- B. 1 x Upper frame
- C. 1 x Shallow bottom runner
- D. 1 x Upper runner
- E. 1 x Door bracket
- F. 1 x Door bracket frame
- G. 1 x Fixing support
- H. 1 x Cover

ATTENTION NOT SUPPLIED

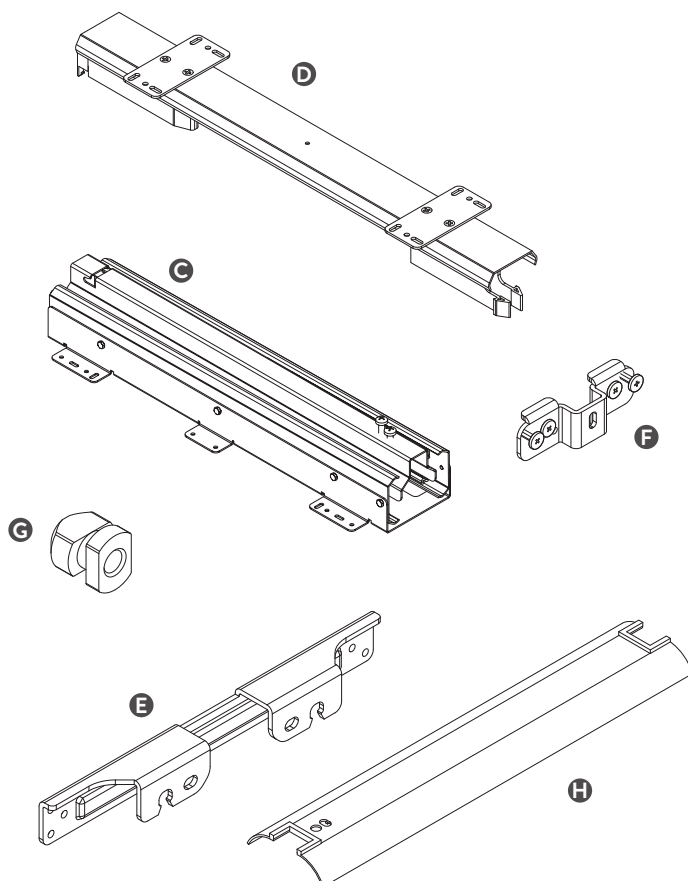
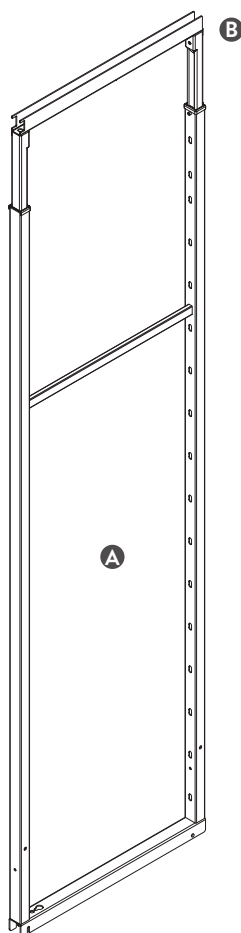
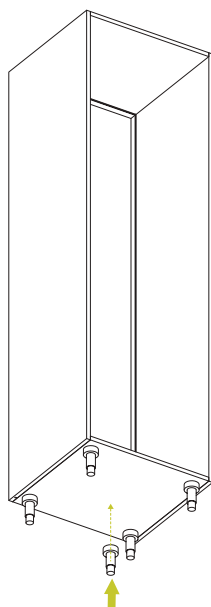

1

8 x 3.5x18 

Set the shallow bottom runner C respecting the distances and with fix the screws provided.

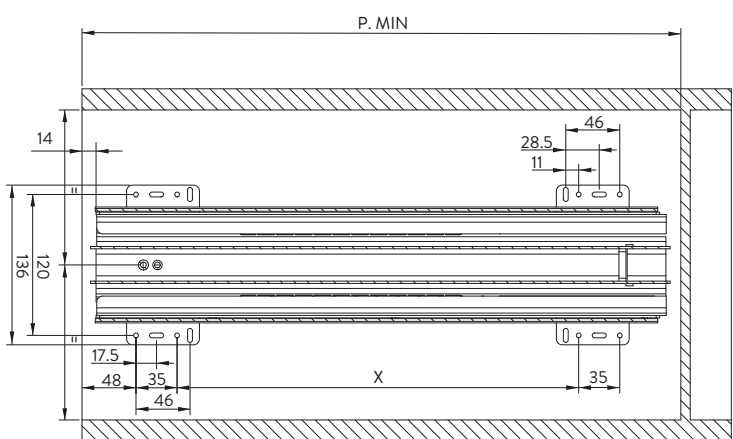
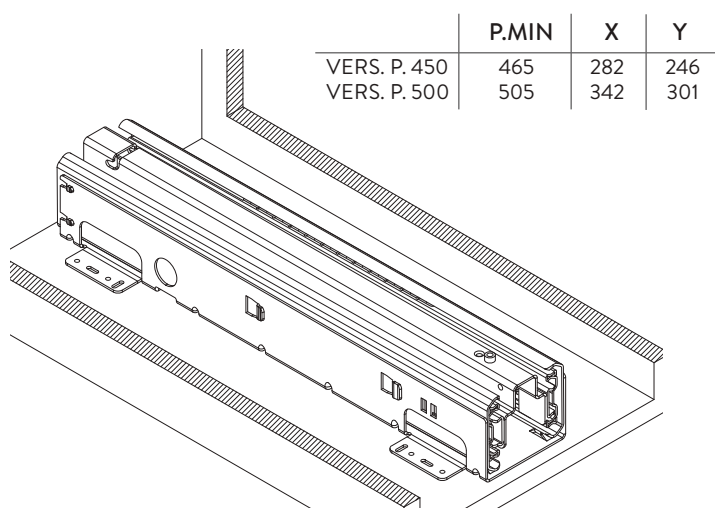

2

4 x 3.5x18 

Set the upper runner D respecting the distances and fix with the screws provided.

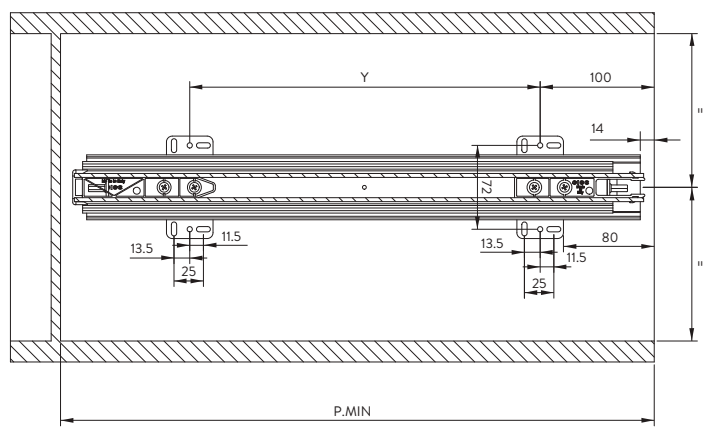
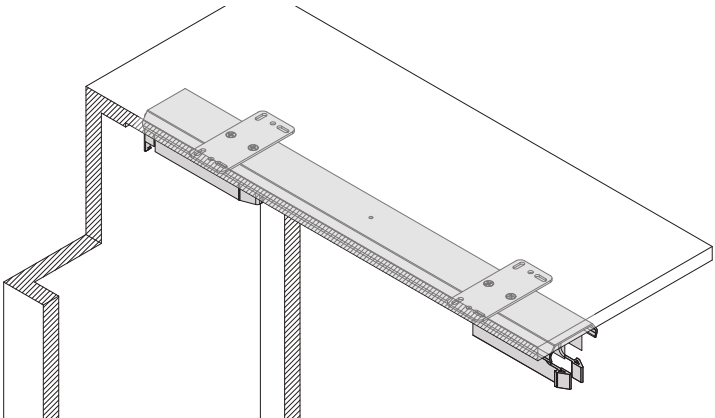

3

1 x M6x16 & 1 x M6x25 

Fix the adjusting screws on the shallow bottom runner C (see the picture).

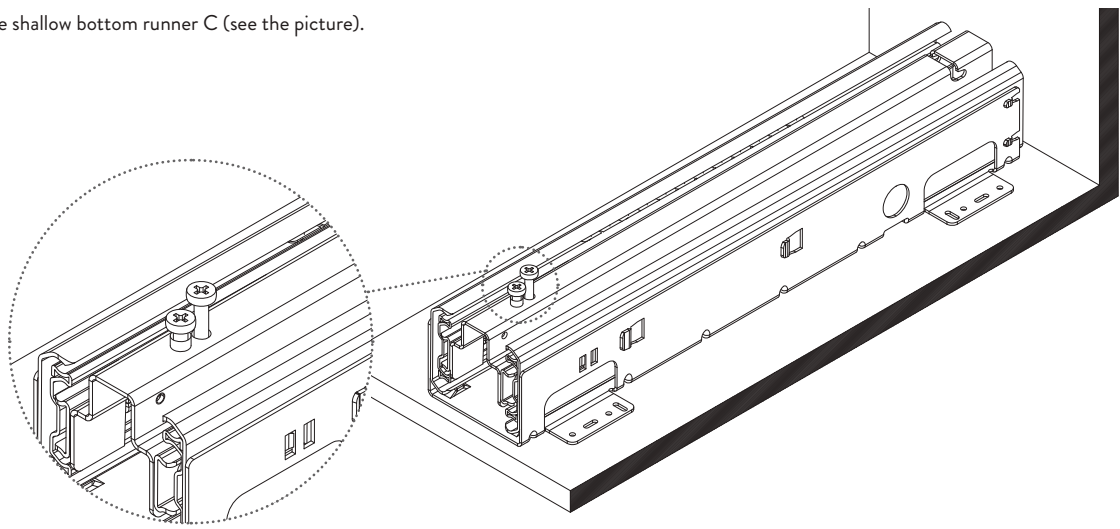

4

Fix the frame A in the shallow bottom runner C open and tighten the screws (see the picture 1).

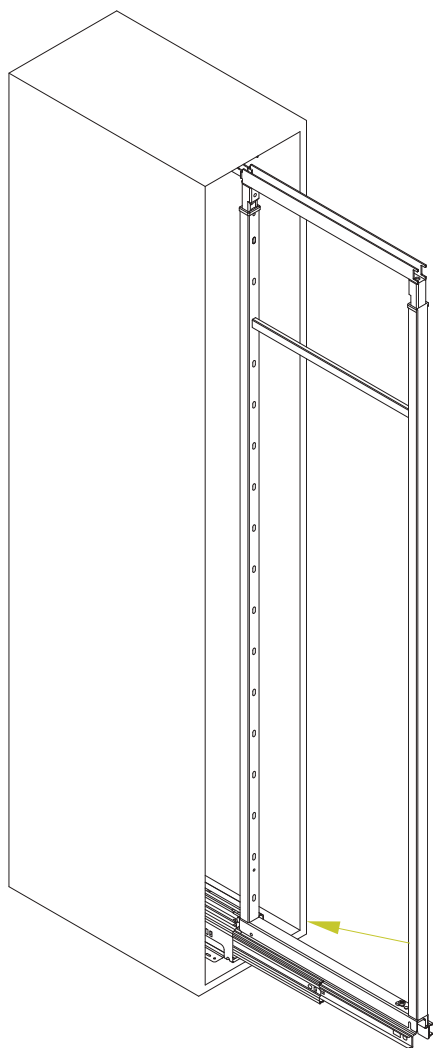
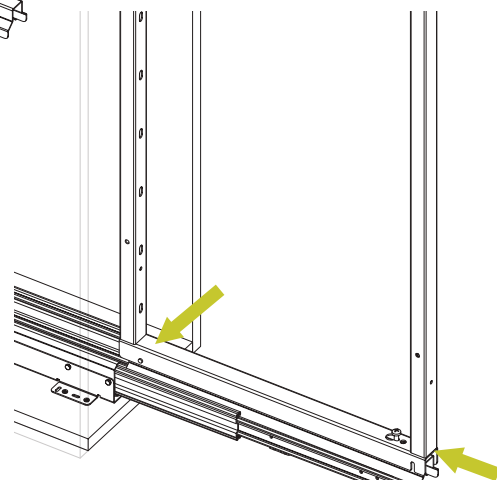
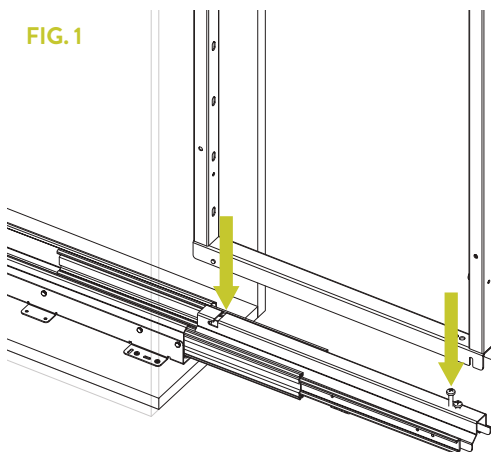
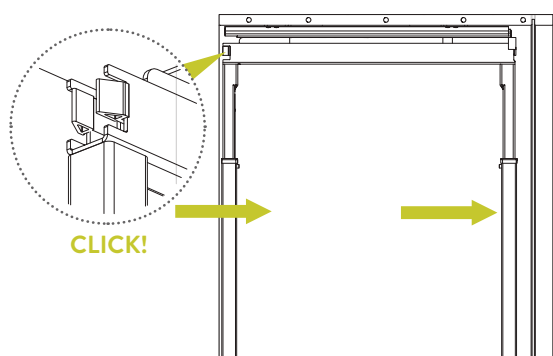
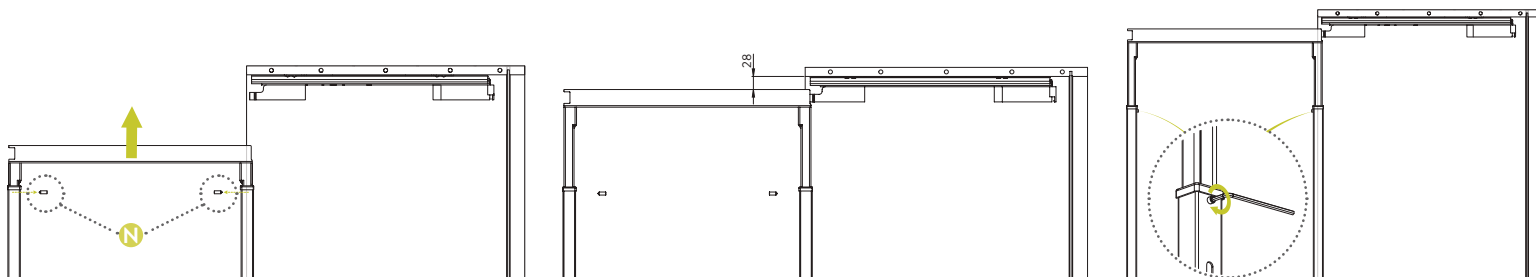

FIG.1



5

Loosen the grains "N" (on the frame A) and slide up the frame B. Block the frame B at the indicated measure by tightening the grains "N". Slide the frame A,B into the top slide D until "Click!" to install.



6

Set the special fixing support G in the frame hole A (see the picture sequence).

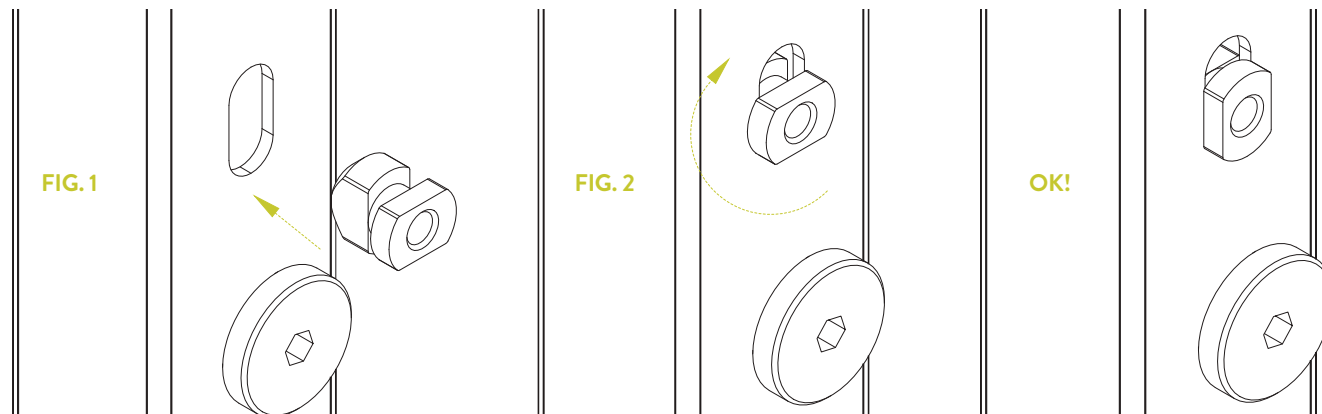

3 x M5x15



Set the door brackets frames F and fix with the special screw.

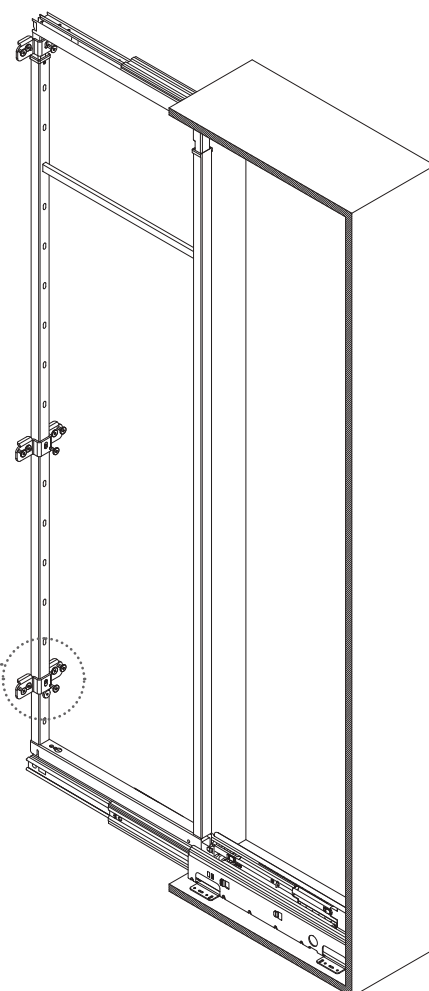
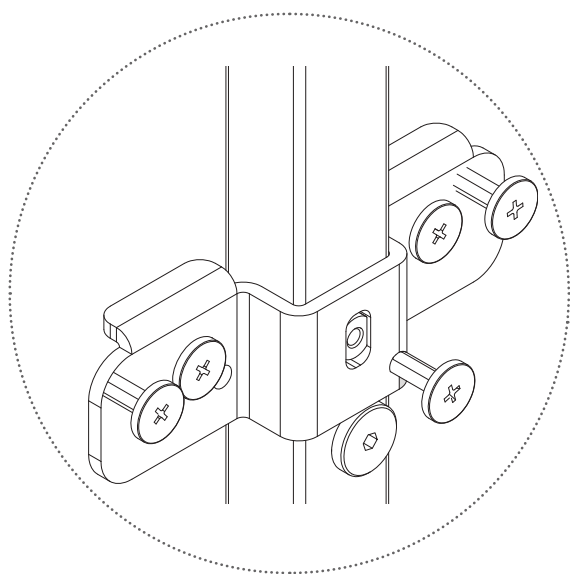

7

12 x 3.5x18



Assemble the door bracket E on the door respecting the distances and set it on the door bracket frame F, already assembled.

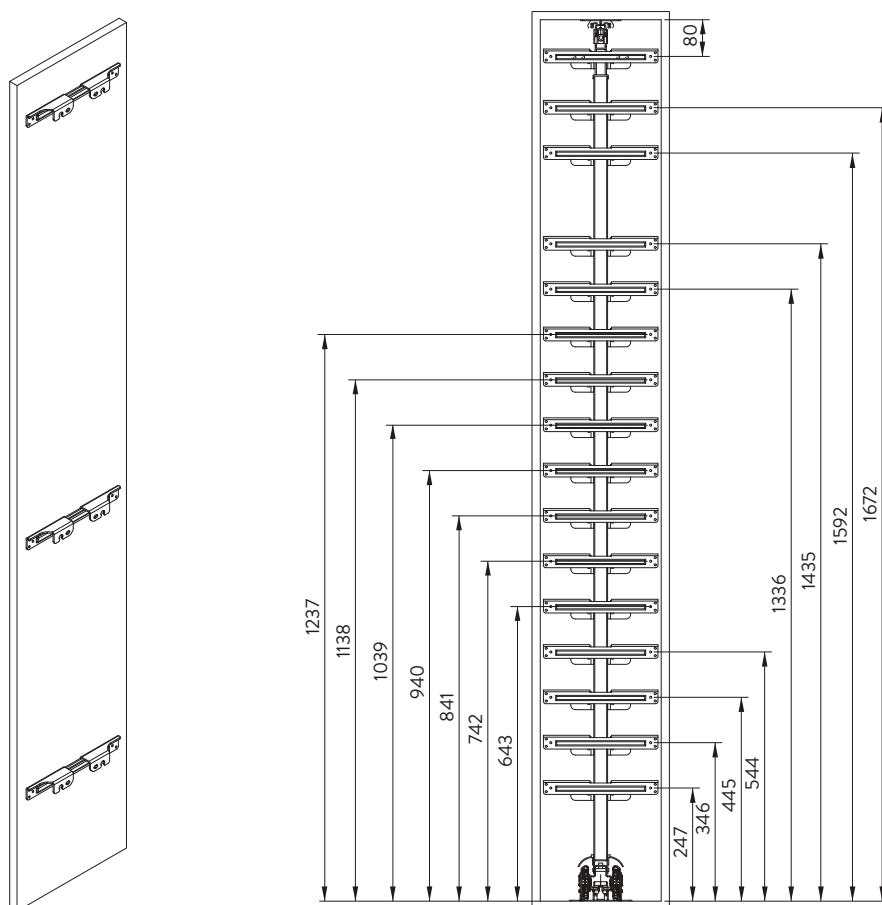

	Z
L 300	218
L 400	318
L 450	368
L 500	418
L 600	518

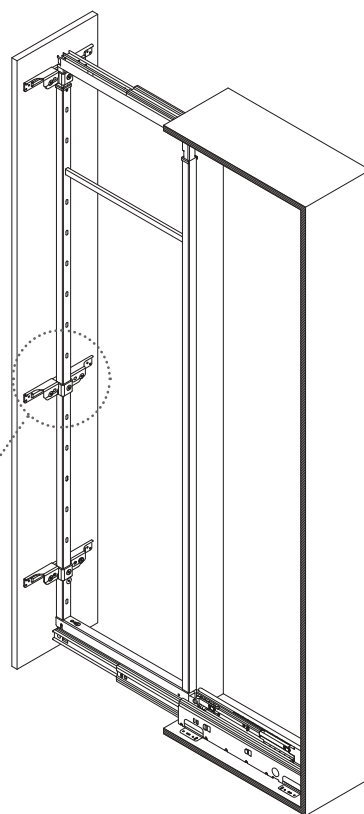
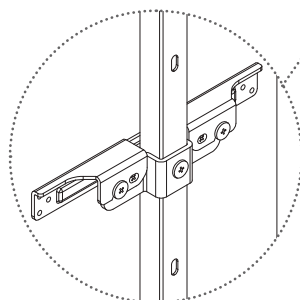
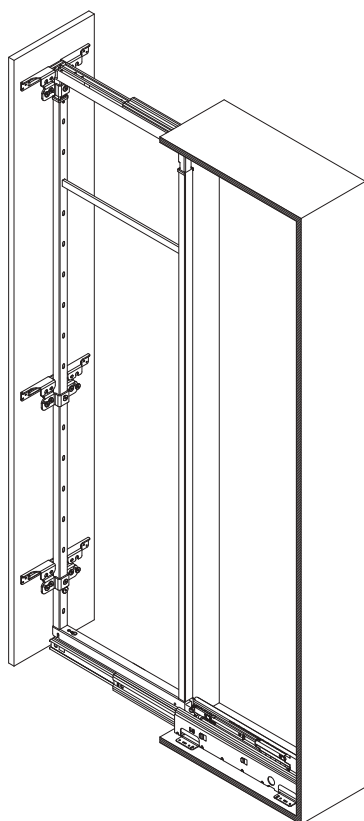
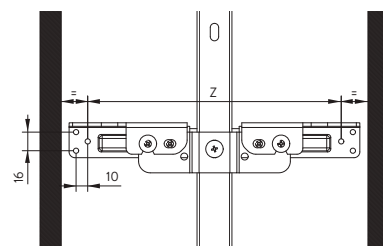

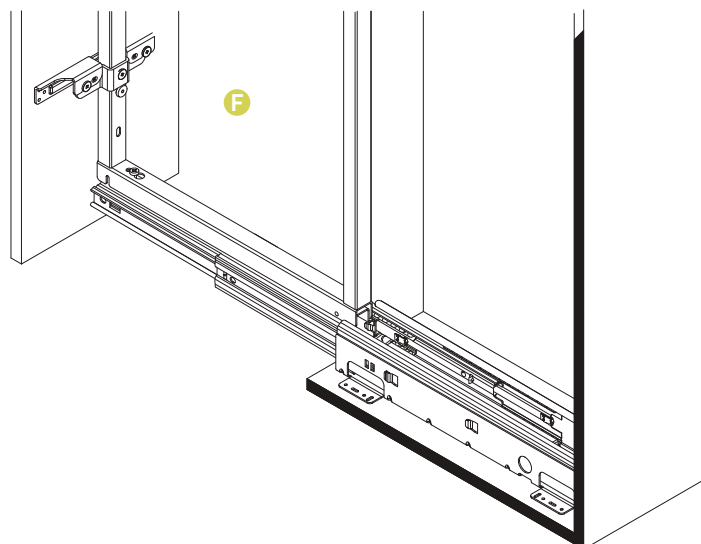
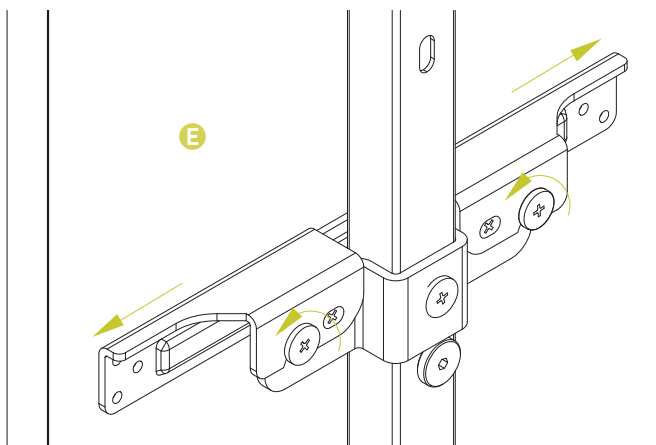
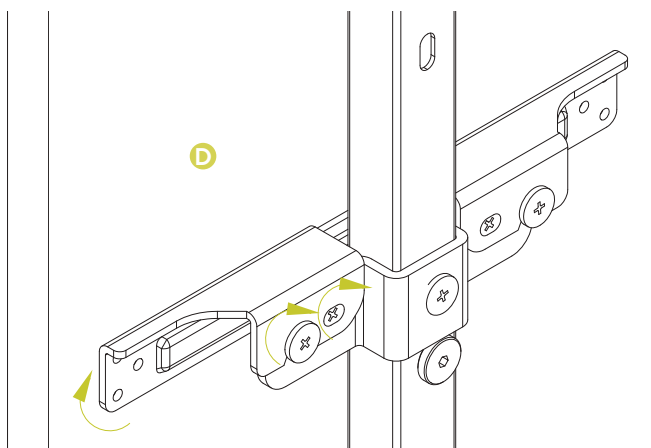
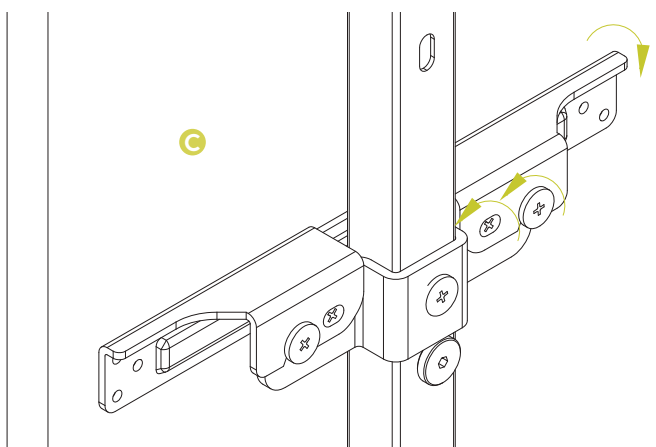
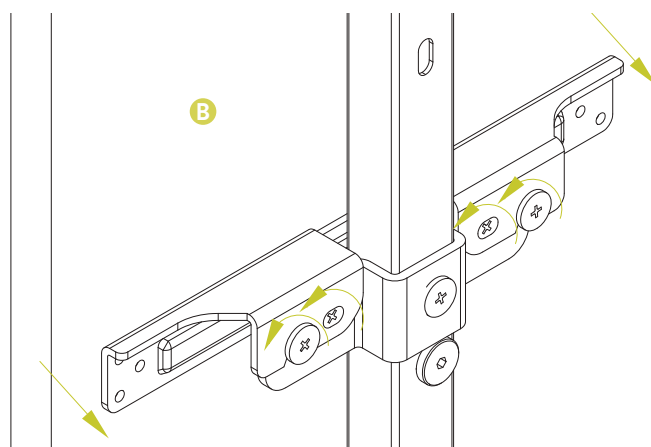
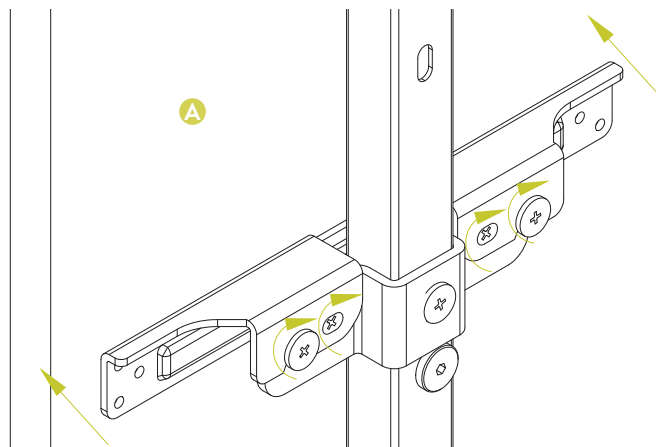

To make the regulation H loosen all the screws of the fixing support F and work on the eccentric situated in the lower part.

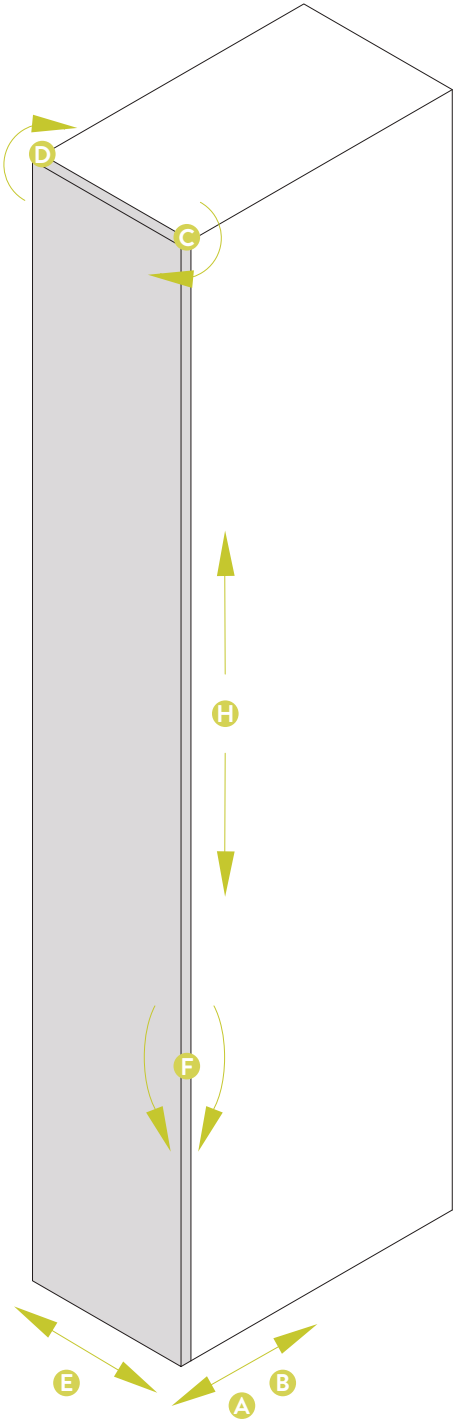
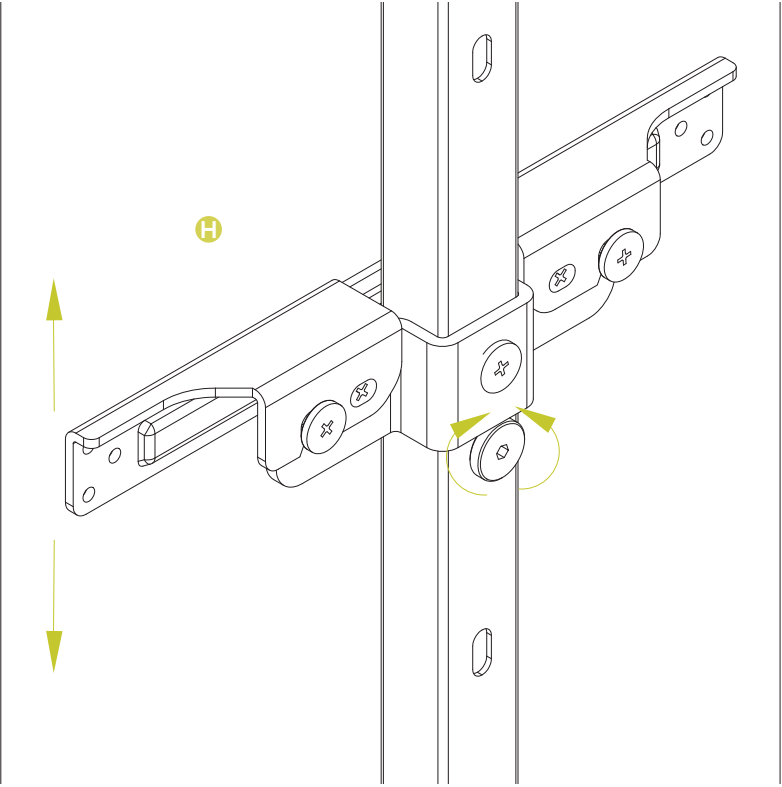

- A-B: Ahead/Back
- C-D: Rotation
- E: Right/Left
- H: High/Low
- F: Regulation door inclination

Insert the cover on the slide.

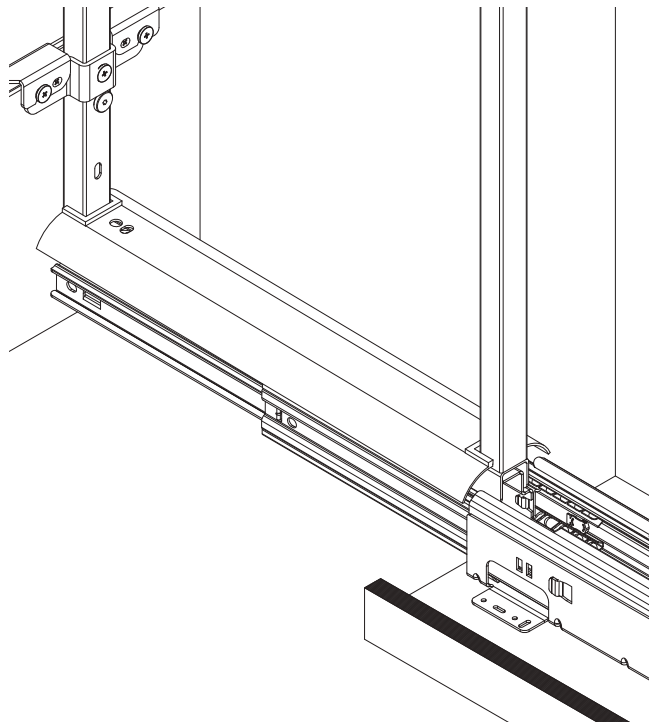
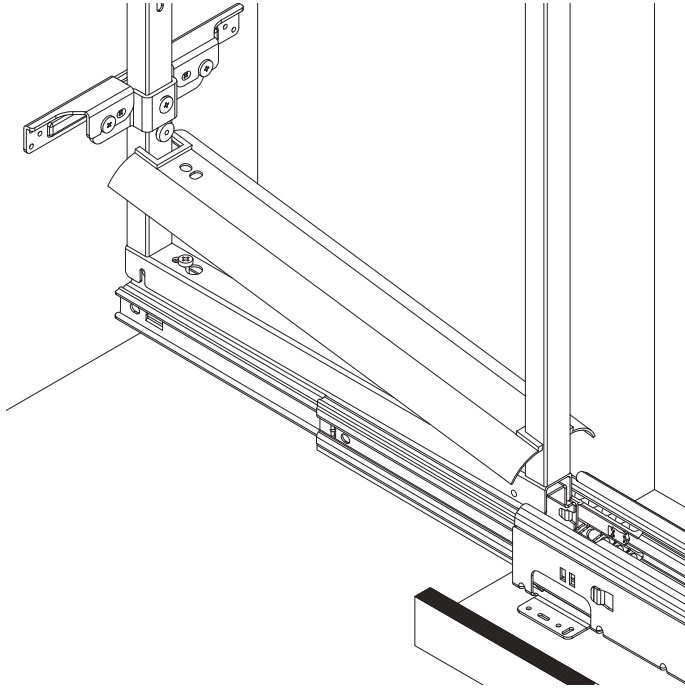

Proline Baskets

ASSEMBLY

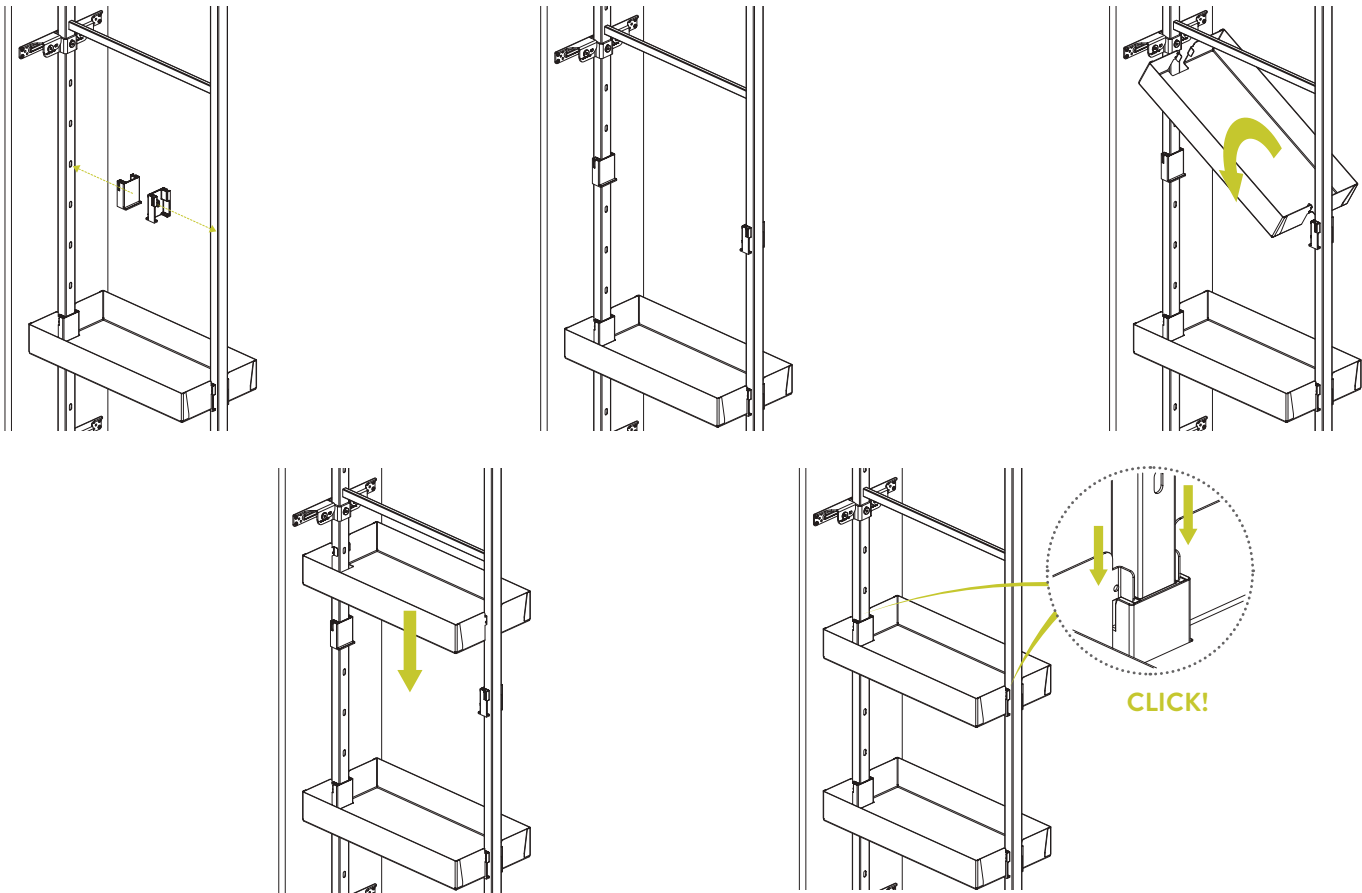

DISASSEMBLY

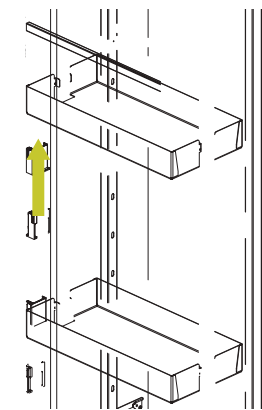

Infinity Baskets

ASSEMBLY

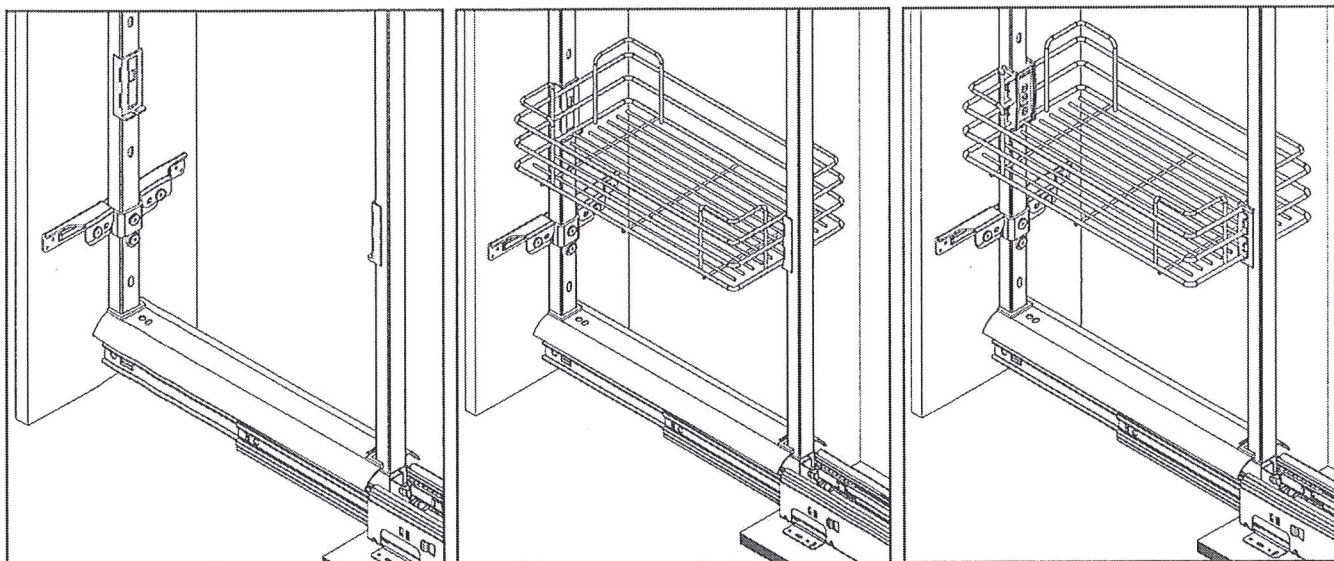

DISASSEMBLY

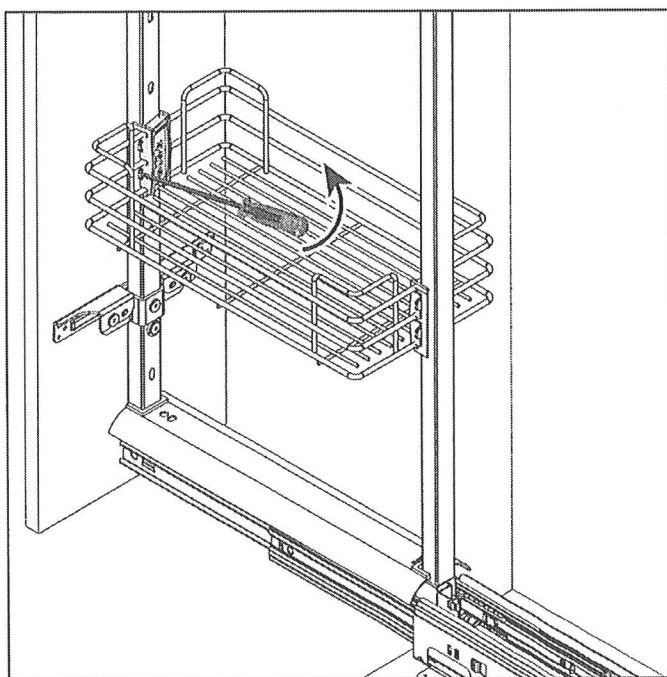

CONTACT US:

PHONE: 0508 365 674

EMAIL: sales@enko.nz

ADDRESS: 14 Winger Crescent, Kamo, Whangarei 0121

WEBSITE: www.enko.nz