

## TOOLS



## FITTINGS

- 14 x 4x16 Self-tapping Screws
- 4 x 6.3x12 Eurovite Screws
- 8 x 3.9x13 Self-tapping Screws
- 2 x M6x10 Screws
- 2 x Washers

## PARTS

- A. 1 x Basket
- C. 1 x Slides Set
- D. 2 x Door Brackets
- E. 1 x Carter Slides Kit
- F. 1 x Spacer Kit for 18/20mm Cabinet Thickness
- G. 1 x Spacer Kit for 16/19mm Cabinet Thickness

Y	SLIDES VERSION D.450	SLIDES VERSION D.500
MIN. DEPTH	445	495

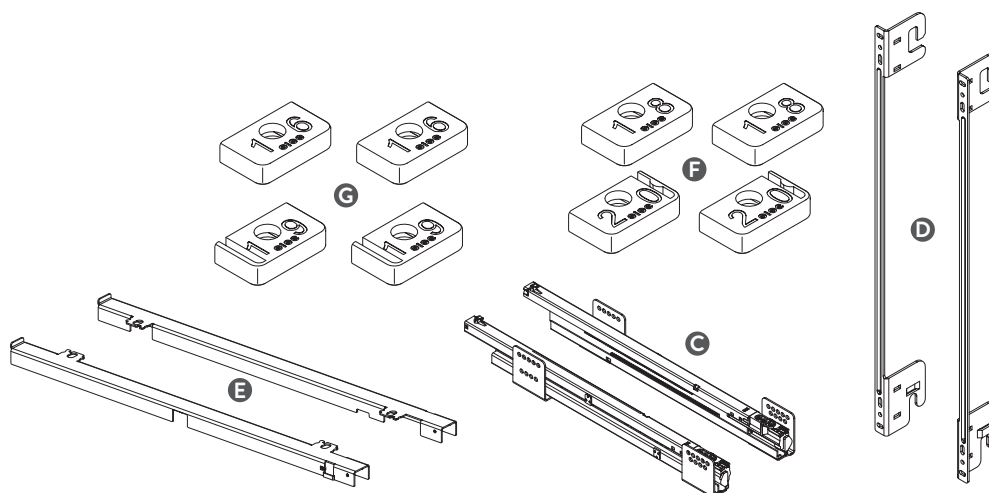
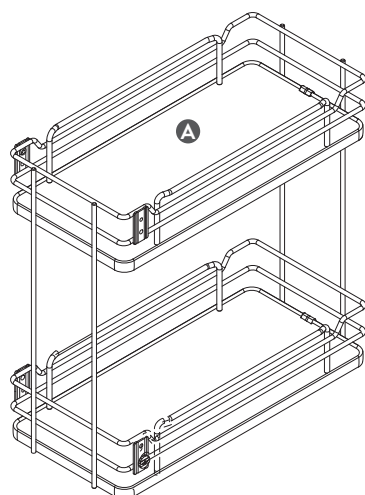

1

8 x 4x16



Place slides C respecting showed data and screw them on the cabinet's sides.  
NB: It's possible to choose slides position either on top or on the bottom to suit your needs.

P.GUIDA  
DEPHT SLIDES

X

450

288

500

320

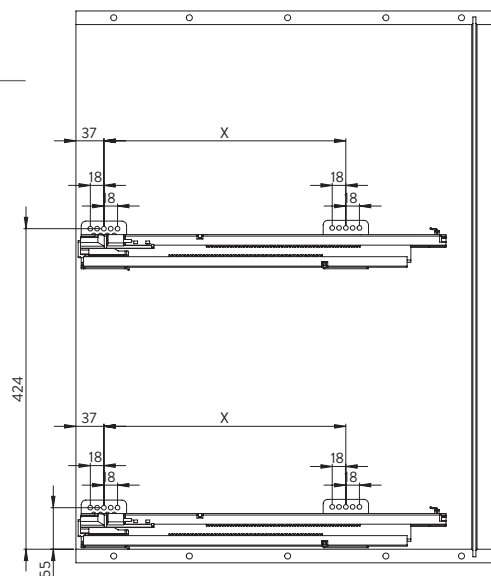
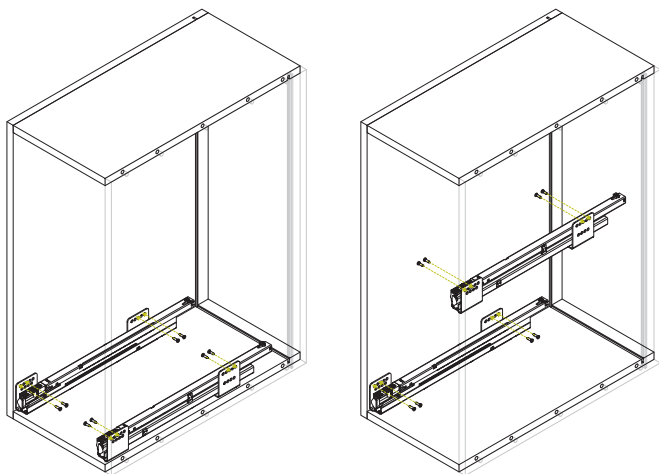

8 x 3.9x13



Screw D brackets on the door respecting showed data.

2

	A
300	241
400	341
450	391
500	441
600	541

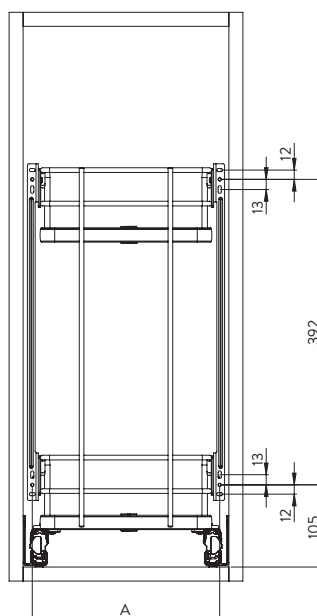
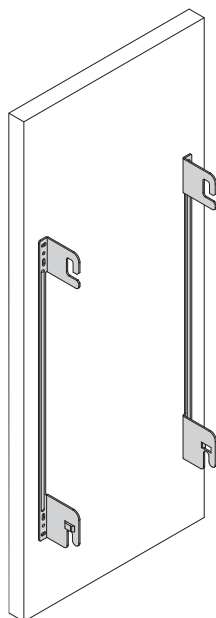

3

Choose the F or G part depending on the cabinet side thickness, as shown in the table\*, Insert the parts in the carter E.

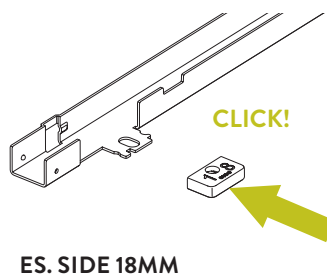

ES. SIDE 18MM

*	CABINET SIDE THICKNESS	PART
	18mm	F
	20mm	
	16mm	G
	19mm	

4 x 6.3x12



4

Screw the carter E onto the shelf using the 6.3x12 eurovites. NB: Place the carter E on the shelves according to how the guides C were previously placed (see step 1).

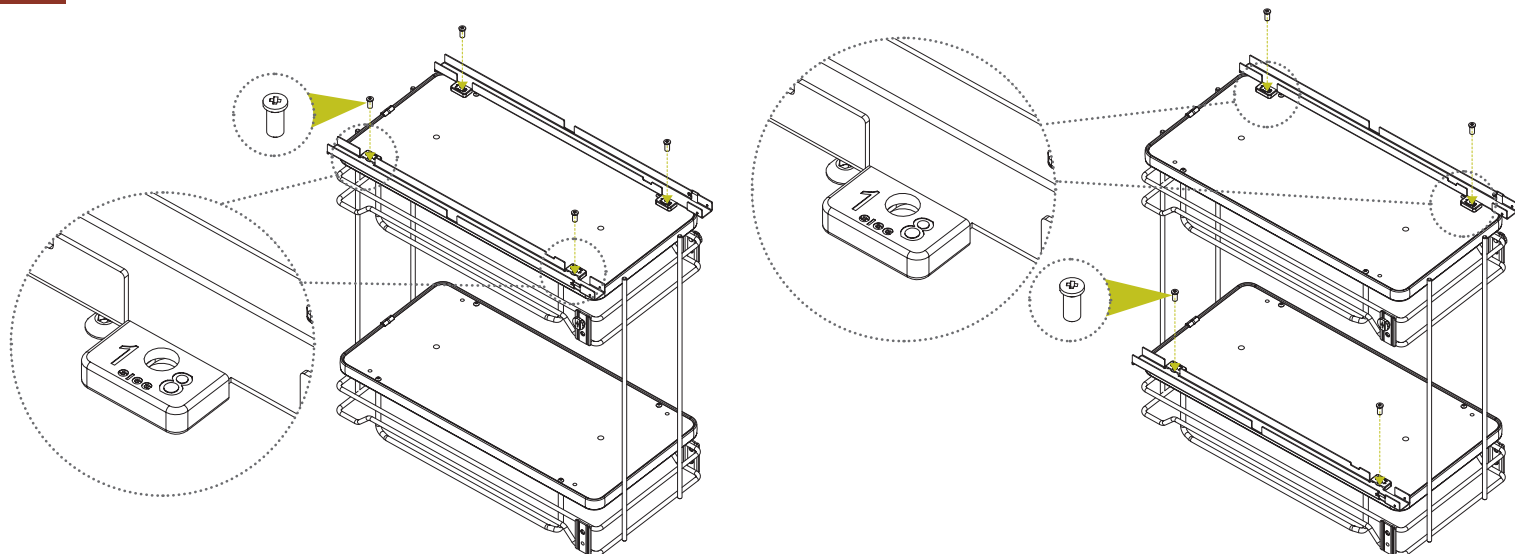

5

Fit basket on slides C.

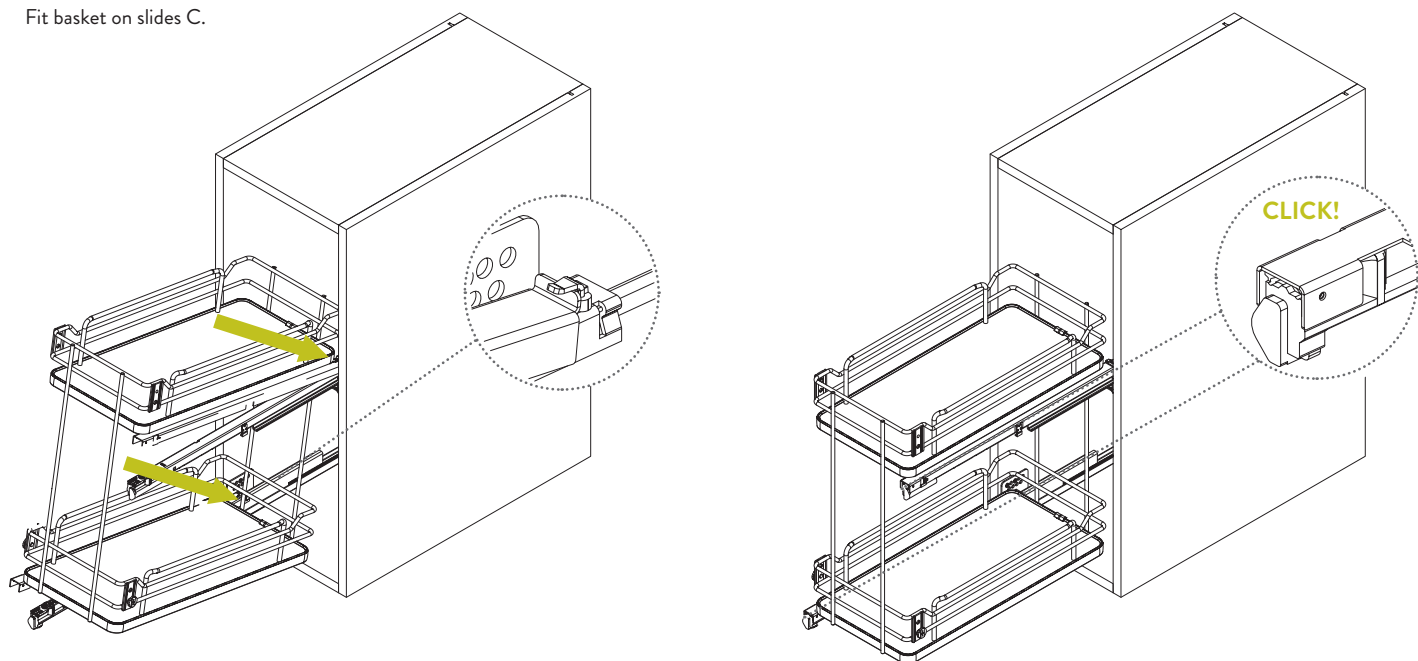

6

2 x M6x10



Pre-assemble the two M6x10 screws and washers as shown in fig. "H", then mount the door and tighten the screws as shown in fig. "I".

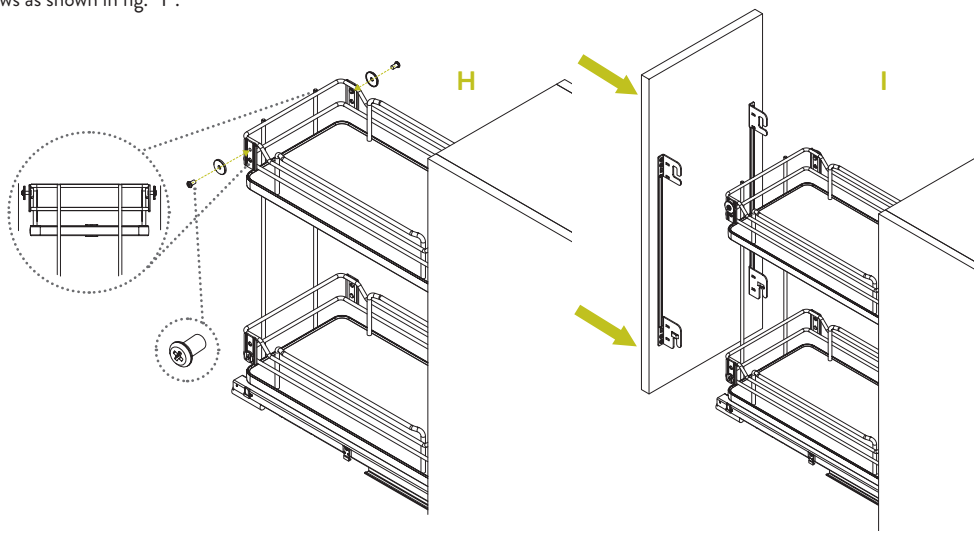



7

Loosen the four screws M6x10 "L", turn the screw "M" as shown to adjust the door up and down.



8

Loosen the four screws M6x10, to adjust the door forward and back.

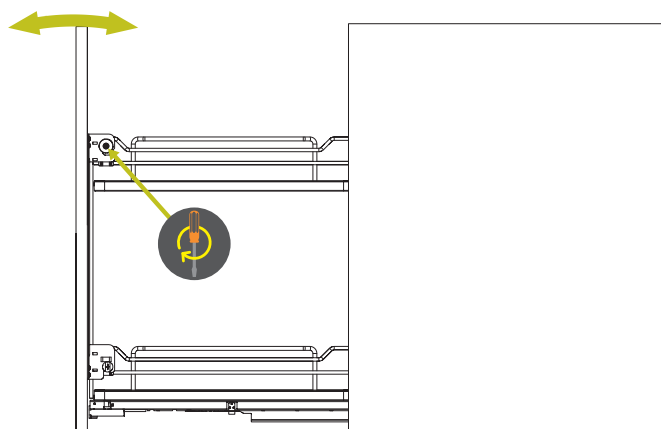

9

Loosen the 3.9x13 screws, to adjust the door to the right and left.

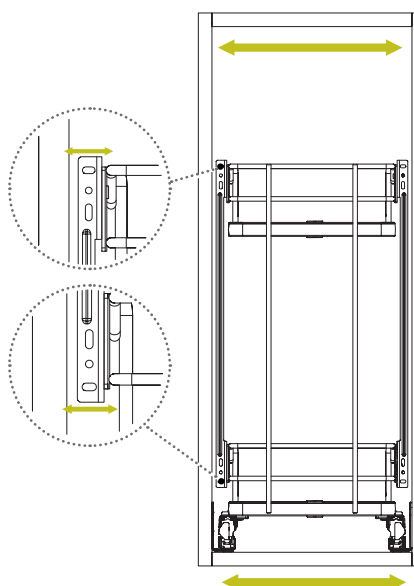

10

Insert bottle dividers.

For SG004i3050

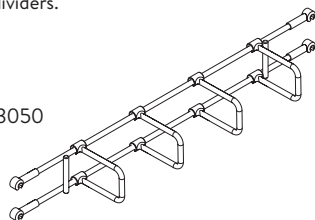

For SG004i4550 & SG004i6050

